

OS & Y RESILIENT WEDGE GATE VALVE

MODEL: SD-OSY175GV

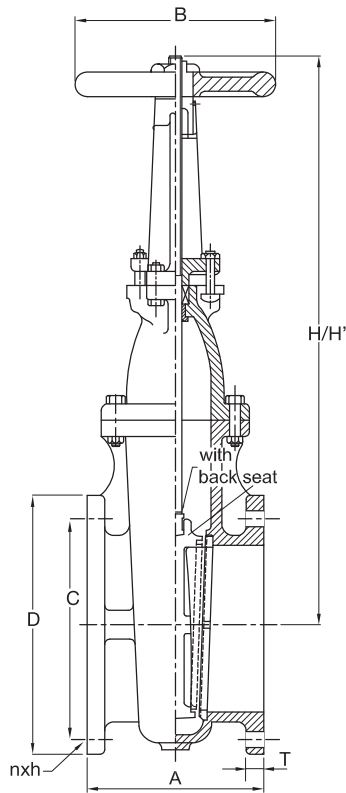

- Outside screw and yoke
- Iron body. Bronze mounted. Solid wedge
- Flanged ends to ANSI B16.1 Class 125
- Working pressure: 175 psi (non-shock cold water pressure)
- Conform to MSS SP-70
- Pregrooved stem for supervisory switch



PART NAME	MATERIAL	ASTM SPEC.
Body	Cast Iron	ASTM A126-iiiB
Disc	Cast Iron	ASTM A126-B
Bonnet	Cast Iron	ASTM A126-B
Packing	Non-Asbestos packing	
Gland	Ductile Iron	A536 65-45-12
Yoke	Cast Iron	ASTM A126-B
Stem	Stainless Steel	AISI 420
Handwheel	Cast Iron	ASTM A126-B

Size	A	B	C	D	H	H'	T	nxh	Net. Wt. Lbs.
2"	178	178	121	152	375	394	15.8	4 x19.1	36
2½"	190	178	140	178	422	454	17.4	4 x19.1	48
3"	203	203	152	191	479	514	19.1	4 x19.1	60
4"	229	254	191	229	594	644	23.8	8 x19.1	103
6"	267	305	241	279	819	860	25.4	8 x 22.2	186
8"	292	356	298	343	1003	1102	28.5	8 x 22.2	298
10"	330	406	363	406	1222	1324	30.1	12 x 25.4	441
12"	356	457	432	483	1422	1524	31.7	12 x 25.4	628

Unit : mm

OS & Y RESILIENT WEDGE GATE VALVE

MODEL: SD-OSY200FF-D



- Working pressure: 200 psi
- Connection ends: Flange to ASME B16.1 Class 125
- Temperature range: 0°C to 80°C
- Coating: Fusion bonded epoxy coating internally and externally in accordance with ANSI/AWWA C550



PART NO.	PART NAME	ASTM SPEC.
1	Valve Body	ASTM A536, 65-45-12
2	Resilient Wedge Disc	ASTM A536, 65-45-12+EPDM
3	Stem	AISI420
4	Bonnet Gasket	EPDM
5	Bonnet	ASTM A536, 65-45-12
6	Washer	Brass Hpb59-1
7	Yoke	ASTM A536, 65-45-12
8	Stem Bushing	Brass Hpb59-1
9	Gland	ASTM A536, 65-45-12
10	Stem Nut	Brass Hpb59-1
11	Hand Wheel	ASTM A536, 65-45-12
12	Washer	Brass Hpb59-1
13	Gland Nut	Carbon Steel Zinc Plated
14	Stud	Carbon Steel Zinc Plated
15	Flat Washer	Carbon Steel Zinc Plated
16	Nut	Carbon Steel Zinc Plated
17	O Ring	EPDM

* Optional for Stem AISI316

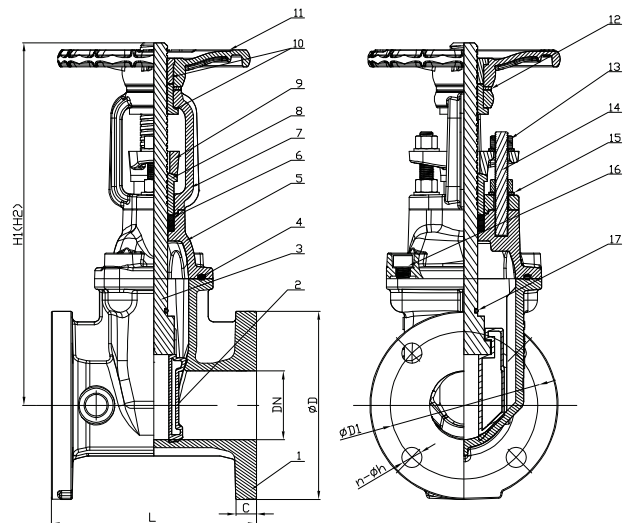

Size	L	H1	H2	D	D1	C	n x h	Net. Wt. Kg.
2"	178	318	370	152	120.7	16	4 x 19.1	14.38
2.5"	190	343	410	178	139.7	17.5	4 x 19.1	17.42
3"	203	386	468	191	152.4	19.1	4 x 19.1	22.83
4"	229	436	538	229	190.5	19.1	8 x 19.1	31.56
5"	254	516	640	254	215.9	19.1	8 x 22.2	41.86
6"	267	576	730	279	241.3	19.1	8 x 22.2	52.23
8"	292	749	950	343	298.5	22.2	8 x 22.2	91.04
10"	330	904	1158	406	362	23.8	12 x 25.4	133.44
12"	356	1030	1335	483	431.8	25.4	12 x 25.4	197.50

* 5" - Only UL Listing

Unit : mm

OS & Y RESILIENT WEDGE GATE VALVE

MODEL: SD-OSY250FF-D



- Working pressure: 250 psi
- Connection ends: Flange to ASME B16.1 Class 125
- Temperature range: 0°C to 80°C
- Coating: Fusion bonded epoxy coating internally and externally in accordance with ANSI/AWWA C550



PART NO.	PART NAME	ASTM SPEC.
1	Valve Body	ASTM A536, 65-45-12
2	Resilient Wedge Disc	ASTM A536, 65-45-12+EPDM
3	Stem	AISI420
4	Bonnet Gasket	EPDM
5	Bonnet	ASTM A536, 65-45-12
6	Washer	Brass Hpb59-1
7	Yoke	ASTM A536, 65-45-12
8	Stem Bushing	Brass Hpb59-1
9	Gland	ASTM A536, 65-45-12
10	Stem Nut	Brass Hpb59-1
11	Hand Wheel	ASTM A536, 65-45-12
12	Washer	Brass Hpb59-1
13	Gland Nut	Carbon Steel Zinc Plated
14	Stud	Carbon Steel Zinc Plated
15	Flat Washer	Carbon Steel Zinc Plated
16	Nut	Carbon Steel Zinc Plated
17	O Ring	EPDM

* Optional for Stem AISI316

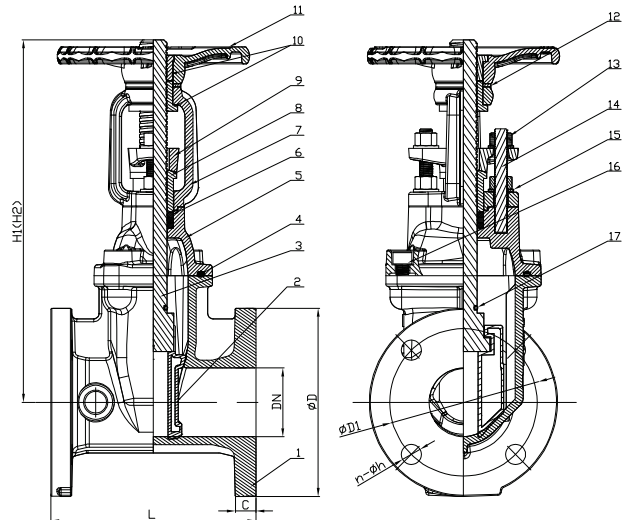

Size	L	H1	H2	D	D1	C	n x ø h	Net. Wt. Kg.
2"	178	318	370	152	120.7	16	4 x 19.1	14.38
2.5"	190	343	410	178	139.7	17.5	4 x 19.1	17.42
3"	203	386	468	191	152.4	19.1	4 x 19.1	22.83
4"	229	436	538	229	190.5	19.1	8 x 19.1	31.56
5"	254	516	640	254	215.9	19.1	8 x 22.2	41.86
6"	267	576	730	279	241.3	19.1	8 x 22.2	52.23
8"	292	749	950	343	298.5	22.2	8 x 22.2	91.04
10"	330	904	1158	406	362	23.8	12 x 25.4	133.44
12"	356	1030	1335	483	431.8	25.4	12 x 25.4	197.50

* 5" - Only UL Listing

Unit : mm

OS & Y RESILIENT WEDGE GATE VALVE

MODEL: SD-OSY300FF-D

- Working pressure: 300 psi
- Connection ends: Flange to ASME B16.1 Class 125
- Temperature range: 0°C to 80°C
- Coating: Fusion bonded epoxy coating internally and externally in accordance with ANSI/AWWA C550



PART NO.	PART NAME	ASTM SPEC.
1	Valve Body	ASTM A536, 65-45-12
2	Resilient Wedge Disc	ASTM A536, 65-45-12+EPDM
3	Stem	AISI420
4	Bonnet Gasket	EPDM
5	Bonnet	ASTM A536, 65-45-12
6	Washer	Brass Hpb59-1
7	Yoke	ASTM A536, 65-45-12
8	Stem Bushing	Brass Hpb59-1
9	Gland	ASTM A536, 65-45-12
10	Stem Nut	Brass Hpb59-1
11	Hand Wheel	ASTM A536, 65-45-12
12	Washer	Brass Hpb59-1
13	Gland Nut	Carbon Steel Zinc Plated
14	Stud	Carbon Steel Zinc Plated
15	Flat Washer	Carbon Steel Zinc Plated
16	Nut	Carbon Steel Zinc Plated
17	O Ring	EPDM

* Optional for Stem AISI316

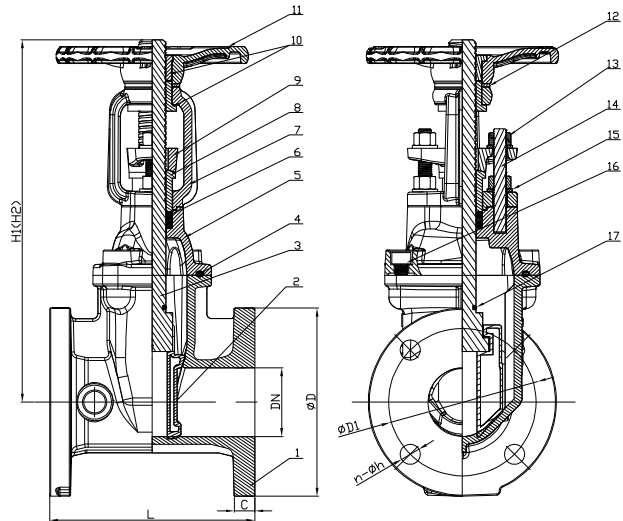

Size	L	H1	H2	D	D1	C	n x ø h	Net. Wt. Kg.
2"	178	318	370	152	120.7	16	4 x19.1	14.38
2.5"	190	343	410	178	139.7	17.5	4 x19.1	17.42
3"	203	386	468	191	152.4	19.1	4 x19.1	22.83
4"	229	436	538	229	190.5	19.1	8 x19.1	31.56
5"	254	516	640	254	215.9	19.1	8 x 22.2	41.86
6"	267	576	730	279	241.3	19.1	8 x 22.2	52.23
8"	292	749	950	343	298.5	22.2	8 x 22.2	91.04
10"	330	904	1158	406	362	23.8	12 x 25.4	133.44
12"	356	1030	1335	483	431.8	25.4	12 x 25.4	197.50

* 5" - Only UL Listing

Unit : mm

OS & Y RESILIENT WEDGE GATE VALVE

MODEL: SD-OSY250GV-D



- Valve complies with AWWA C515
- Working Pressure 250 psi. Cold water pressure (Max. temp. 63°C)
- Flanged Ends to ANSI B16.1 Class 125
- Pre-grooved stem for supervisory switch
- Epoxy coated interior / exterior to AWWA C550

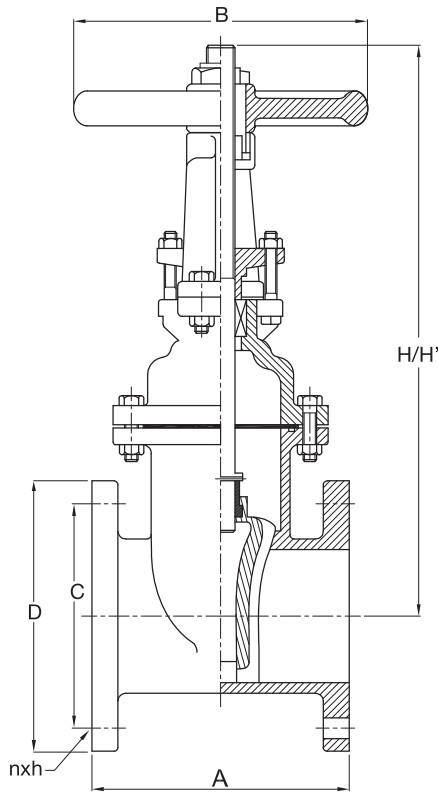
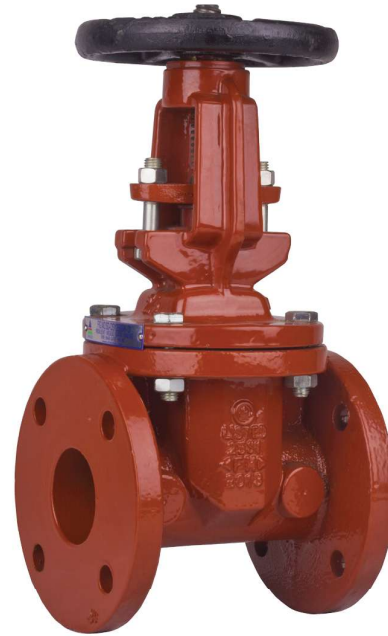

PART NAME	MATERIAL	ASTM SPEC.
Body	Ductile Iron	ASTM A536 65-45-12
Wedge	Ductile Iron coated with EPDM	
Bonnet	Ductile Iron	ASTM A536 65-45-12
Packing	Graphite packing	
Gland Flange	Ductile Iron	A536 65-45-12
Yoke Sleeve	Cast Bronze	ASTM B62
Stem	Stainless Steel	AISI 420
Handwheel	Cast Iron	ASTM A126-B

Size	A	B	C	D	H	H'	nxh
2½"	190	178	140	178	324	378	4 x19.1
3"	203	254	152	191	483	559	4 x19.1
4"	229	254	191	229	495	597	8 x19.1
6"	267	305	241	279	664	816	8 x 22.2
8"	292	356	298	343	816	1019	8 x 22.2
10"	330	406	363	406	1019	1273	12 x 25.4
12"	356	457	432	483	1191	1505	12 x 25.4

Unit : mm

OS & Y RESILIENT WEDGE GATE VALVE

MODEL: SD-OSY250FF-D1



SI No.	Part Name	ASTM Spec.	Material
1	Body	ASTM A536	Ductile Iron
2	Wedge	ASTM A536 + ASTM D2000	Ductile Iron + EPDM
3	Stem Trim	ASTM B584	Bronze
4	Retainer	ASTM A276, SS304	Stainless Steel
5	O-Ring	ASTM D2000	EPDM
6	Stem	ASTM A276, SS304	Stainless Steel
7	Stem Gasket	ASTM D2000	EPDM
8	Inside Hexagonal Bolt	ASTM A574M	Alloy Steel, Zinc Plated
9	Bonnet	ASTM A536	Ductile Iron
10	Stuffing	ASTM D2000	EPDM
11	Threaded Rod	ASTM A307	Carbon Steel
12	Stuffing Bushing	ASTM B584	Bronze
13	Stuffing Gland	ASTM A536	Ductile Iron
14	Nut	ASTM B16-H02	Brass
15	Inside Hexagonal Bolt	ASTM A574M	Alloy Steel, Zinc Plated
16	Yoke	ASTM A536	Ductile Iron
17	Flat Point Set Screw	ASTM F912M	Alloy Steel
18	Gland	ASTM A126-B	Cast Iron
19	Handwheel	ASTM A536	Ductile Iron
20	Stem Nut	ASTM B584	Bronze
21	Handwheel Nut	ASTM A194-2H	Carbon Steel
22	Label	---	Aluminium
23	Screw	ASTM A276, SS304	Stainless Steel
24	Plug, Pipe	---	Steel, ASME B16.14

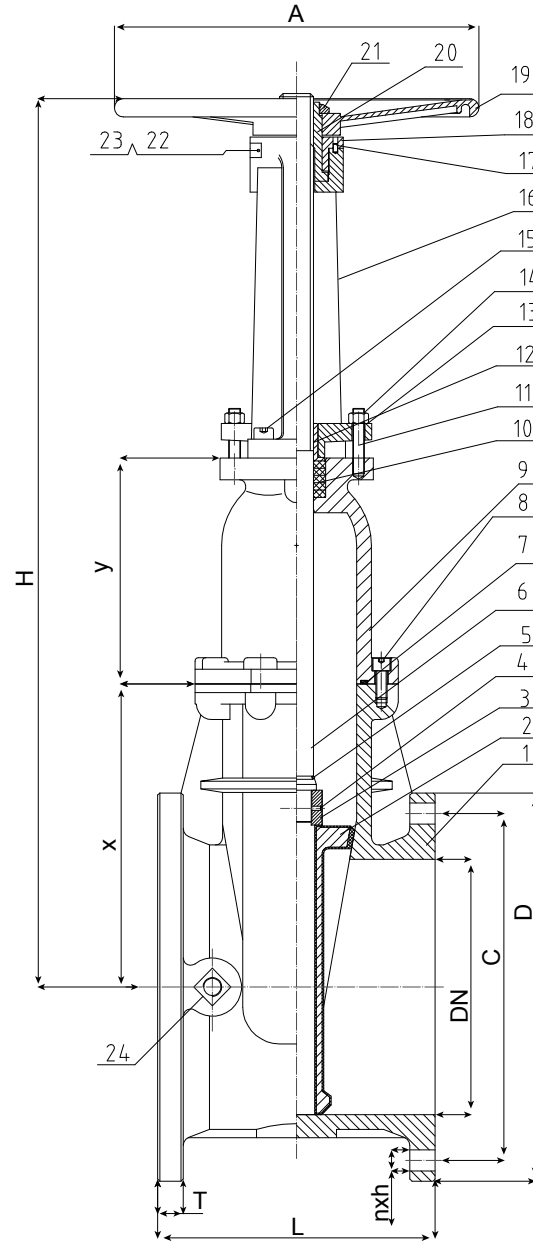

Size	L	H	A	C	D	T	nxh	x	y
14"	381 ± 1.5	1219	500	476	533	35	12x29	416	310
16"	406 ± 1.5	1288	500	539.5	597	37	16x29	406	381

Unit : mm

OS & Y RESILIENT WEDGE GATE VALVE

MODEL: SD-OSY250FF-D1



Sl. No.	Part Name	ASTM Spec	Material
1	Body	ASTM A 536 65-45-12	Ductile Iron
2	Wedge	Ductile Iron + EPDM Encapsulated	
3	Wedge Nut	ASTM B62 C83600	Bronze
4	Stem	AISI 304	Stainless Steel
5	Gasket	EPDM	Rubber
6	Bolt	ASTM A307 B	Carbon Steel
7	Nuts	ASTM A307 B	Carbon Steel
8	Spacer	ASTM A307 B	Carbon Steel
9	Bonnet	ASTM A 536 65-45-12	Ductile Iron
10	Bolts	ASTM A307 B	Carbon Steel
11	Packing	Commercial	Graphite
12	Collar	---	Brass
13	Gland	ASTM A 536 65-45-12	Ductile Iron
14	Shaft	ASTM A 536 65-45-12	Ductile Iron
15	Stem Nut	---	Brass
16	Spacer	---	Brass
17	Nuts	---	Brass
18	Bolts	ASTM A307 B	Carbon Steel
19	Handwheel Nut	ASTM A 536 65-45-12	Ductile Iron
20	Handwheel	ASTM A 536 65-45-12	Ductile Iron
21	Stud	AISI 304	Stainless Steel
22	Nuts	AISI 304	Stainless Steel
23	O-Ring	EPDM	Rubber
24	Pin	---	2Cr13
25	Eye Bolts	ASTM A307 B	Carbon Steel
26	Spacer	ASTM A307 B	Carbon Steel
27	Plug	---	Steel

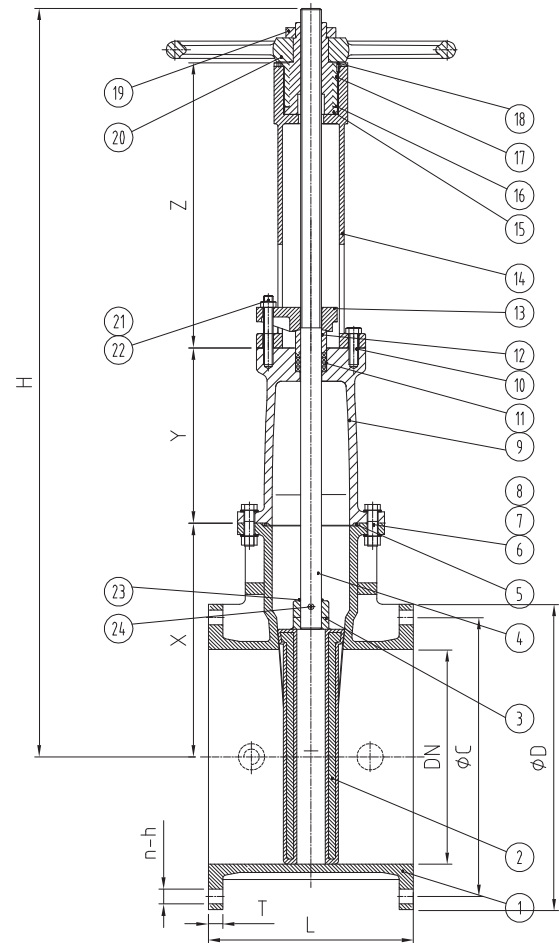

Size	L	H (Open)	H (Closed)	T	ØD	ØC	R	DN	nxh	X	Y	Z
18	432	2020	1570	39.7	635	578	610	450	16 - Ø32	490	367.5	598

Unit : mm

OS & Y RESILIENT WEDGE GATE VALVE

MODEL: SD-OSY200FF-D1



Sl. No.	Part Name	ASTM Spec	Material
1	Body	ASTM A 536 65-45-12	Ductile Iron
2	Wedge	Ductile Iron + EPDM Encapsulated	
3	Wedge Nut	ASTM B62 C83600	Bronze
4	Stem	AISI 304	Stainless Steel
5	Gasket	EPDM	Rubber
6	Bolt	ASTM A307 B	Carbon Steel
7	Nuts	ASTM A307 B	Carbon Steel
8	Spacer	ASTM A307 B	Carbon Steel
9	Bonnet	ASTM A 536 65-45-12	Ductile Iron
10	Bolts	ASTM A307 B	Carbon Steel
11	Packing	Commercial	Graphite
12	Collar	---	Brass
13	Gland	ASTM A 536 65-45-12	Ductile Iron
14	Shaft	ASTM A 536 65-45-12	Ductile Iron
15	Stem Nut	---	Brass
16	Spacer	---	Brass
17	Nuts	---	Brass
18	Bolts	ASTM A307 B	Carbon Steel
19	Handwheel Nut	ASTM A 536 65-45-12	Ductile Iron
20	Handwheel	ASTM A 536 65-45-12	Ductile Iron
21	Stud	AISI 304	Stainless Steel
22	Nuts	AISI 304	Stainless Steel
23	O-Ring	EPDM	Rubber
24	Pin	---	2Cr13
25	Eye Bolts	ASTM A307 B	Carbon Steel
26	Spacer	ASTM A307 B	Carbon Steel
27	Plug	---	Steel

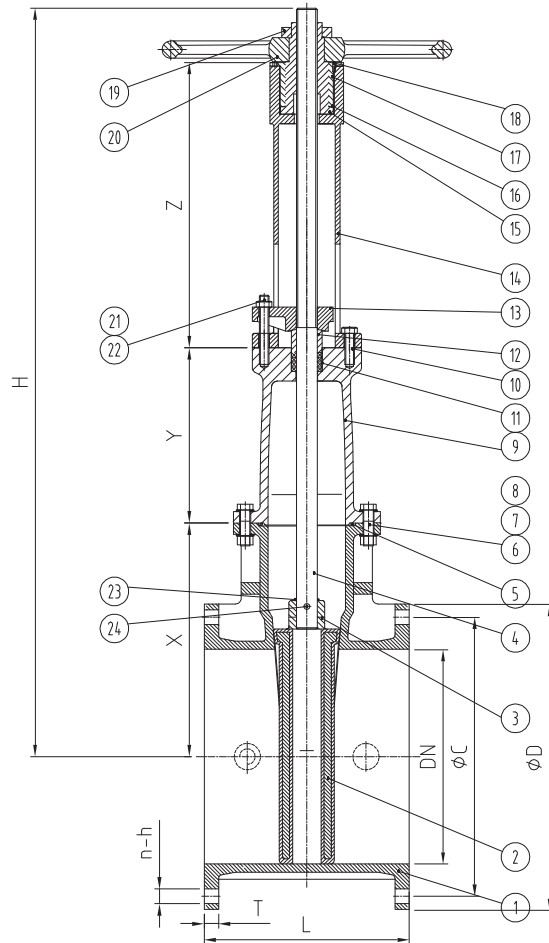

Size	L	H (Open)	H (Closed)	T	ØD	ØC	R	DN	nxh	X	Y	Z
20	457	2276	1776	42.9	699	635	610	500	20 - Ø32	625	317.5	667
24	508	2600	2000	47.7	813	749	762	600	20 - Ø35	722	381	737

Unit : mm

OS & Y GROOVED RESILIENT GATE VALVE

MODEL: SD-OSY200GG-D



- Working pressure: 200 psi
- Connection ends: Grooved to AWWA C606
- Temperature range: 0°C to 80°C
- Coating: Fusion bonded epoxy coating internally and externally in accordance with ANSI/AWWA C550



PART NO.	PART NAME	ASTM SPEC.
1	Valve Body	ASTM A536, 65-45-12
2	Resilient Wedge Disc	ASTM A536, 65-45-12+EPDM
3	Stem	AISI420
4	Bonnet Gasket	EPDM
5	Bonnet	ASTM A536, 65-45-12
6	Washer	Brass Hpb59-1
7	Yoke	ASTM A536, 65-45-12
8	Stem Bushing	Brass Hpb59-1
9	Gland	ASTM A536, 65-45-12
10	Stem Nut	Brass Hpb59-1
11	Hand Wheel	ASTM A536, 65-45-12
12	Washer	Brass Hpb59-1
13	Gland Nut	Carbon Steel Zinc Plated
14	Stud	Carbon Steel Zinc Plated
15	Flat Washer	Carbon Steel Zinc Plated
16	Nut	Carbon Steel Zinc Plated
17	O Ring	EPDM

* Optional for Stem AISI316

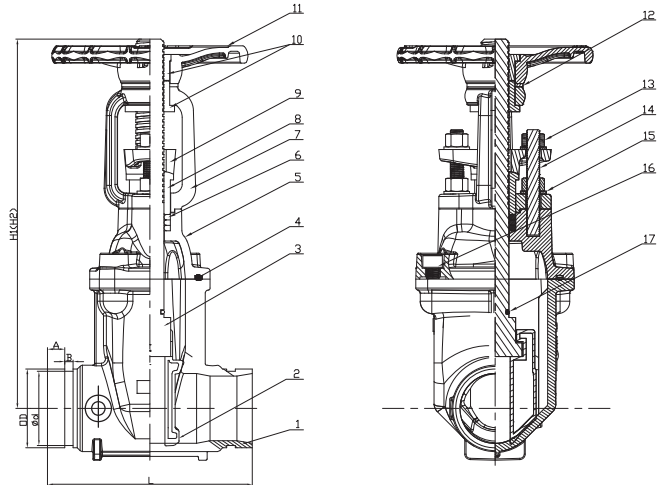

Size	L	H1	H2	OD	d	A	B	Net. Wt. Kg.
2"	178	318	370	60.3	57.15	15.88	7.92	11.08
2.5"	190	343	410	73	69.09	15.88	7.92	12.22
3"	203	386	468	88.9	84.94	15.88	7.92	16.67
4"	229	436	538	114.3	110.08	15.88	9.52	23.89
5"	254	516	640	141.3	137.03	15.88	9.52	33.08
6"	267	576	730	168.3	163.96	15.88	9.52	40.41
8"	292	749	950	219.1	214.4	19.05	11.13	73.40
10"	330	904	1158	273	268.28	19.05	12.7	121.16
12"	356	1030	1335	323.9	318.29	19.05	12.7	172.02

* 5" - Only UL Listing

Unit : mm

OS & Y GROOVED RESILIENT GATE VALVE

MODEL: SD-OSY250GG-D



- Working pressure: 250 psi
- Connection ends: Grooved to AWWA C606
- Temperature range: 0°C to 80°C
- Coating: Fusion bonded epoxy coating internally and externally in accordance with ANSI/ AWWA C550



PART NO.	PART NAME	ASTM SPEC.
1	Valve Body	ASTM A536, 65-45-12
2	Resilient Wedge Disc	ASTM A536, 65-45-12+EPDM
3	Stem	AISI420
4	Bonnet Gasket	EPDM
5	Bonnet	ASTM A536, 65-45-12
6	Washer	Brass Hpb59-1
7	Yoke	ASTM A536, 65-45-12
8	Stem Bushing	Brass Hpb59-1
9	Gland	ASTM A536, 65-45-12
10	Stem Nut	Brass Hpb59-1
11	Hand Wheel	ASTM A536, 65-45-12
12	Washer	Brass Hpb59-1
13	Gland Nut	Carbon Steel Zinc Plated
14	Stud	Carbon Steel Zinc Plated
15	Flat Washer	Carbon Steel Zinc Plated
16	Nut	Carbon Steel Zinc Plated
17	O Ring	EPDM

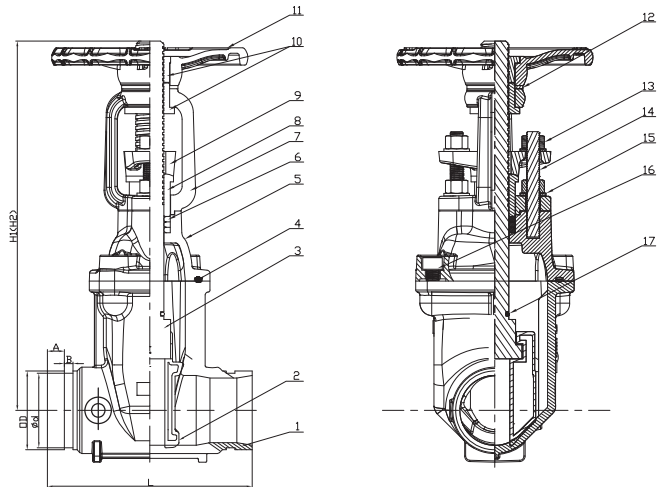

* Optional for Stem AISI316

Size	L	H1	H2	OD	d	A	B	Net. Wt. Kg.
2"	178	318	370	60.3	57.15	15.88	7.92	11.08
2.5"	190	343	410	73	69.09	15.88	7.92	12.22
3"	203	386	468	88.9	84.94	15.88	7.92	16.67
4"	229	436	538	114.3	110.08	15.88	9.52	23.89
5"	254	516	640	141.3	137.03	15.88	9.52	33.08
6"	267	576	730	168.3	163.96	15.88	9.52	40.41
8"	292	749	950	219.1	214.4	19.05	11.13	73.40
10"	330	904	1158	273	268.28	19.05	12.7	121.16
12"	356	1030	1335	323.9	318.29	19.05	12.7	172.02

* 5" - Only UL Listing

Unit : mm

OS & Y GROOVED RESILIENT GATE VALVE

MODEL: SD-OSY300GG-D

- Working pressure: 300 psi
- Connection ends: Grooved to AWWA C606
- Temperature range: 0°C to 80°C
- Coating: Fusion bonded epoxy coating internally and externally in accordance with ANSI/AWWA C550



PART NO.	PART NAME	ASTM SPEC.
1	Valve Body	ASTM A536, 65-45-12
2	Resilient Wedge Disc	ASTM A536, 65-45-12+EPDM
3	Stem	AISI420
4	Bonnet Gasket	EPDM
5	Bonnet	ASTM A536, 65-45-12
6	Washer	Brass Hpb59-1
7	Yoke	ASTM A536, 65-45-12
8	Stem Bushing	Brass Hpb59-1
9	Gland	ASTM A536, 65-45-12
10	Stem Nut	Brass Hpb59-1
11	Hand Wheel	ASTM A536, 65-45-12
12	Washer	Brass Hpb59-1
13	Gland Nut	Carbon Steel Zinc Plated
14	Stud	Carbon Steel Zinc Plated
15	Flat Washer	Carbon Steel Zinc Plated
16	Nut	Carbon Steel Zinc Plated
17	O Ring	EPDM

* Optional for Stem AISI316

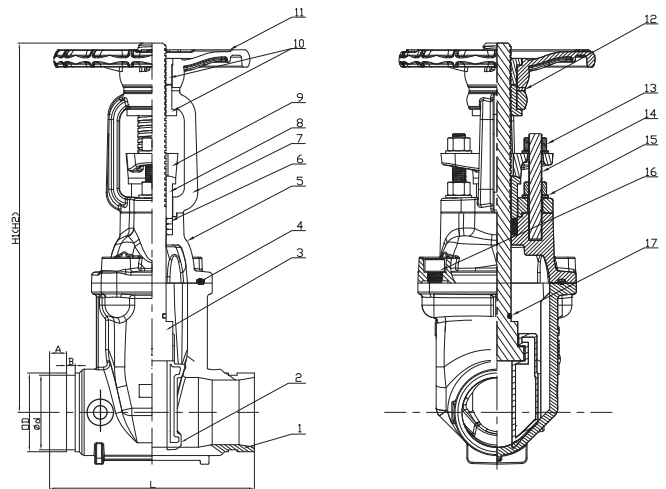

Size	L	H1	H2	OD	d	A	B	Net. Wt. Kg.
2"	178	318	370	60.3	57.15	15.88	7.92	11.08
2.5"	190	343	410	73	69.09	15.88	7.92	12.22
3"	203	386	468	88.9	84.94	15.88	7.92	16.67
4"	229	436	538	114.3	110.08	15.88	9.52	23.89
5"	254	516	640	141.3	137.03	15.88	9.52	33.08
6"	267	576	730	168.3	163.96	15.88	9.52	40.41
8"	292	749	950	219.1	214.4	19.05	11.13	73.40
10"	330	904	1158	273	268.28	19.05	12.7	121.16
12"	356	1030	1335	323.9	318.29	19.05	12.7	172.02

* 5" - Only UL Listing

Unit : mm